

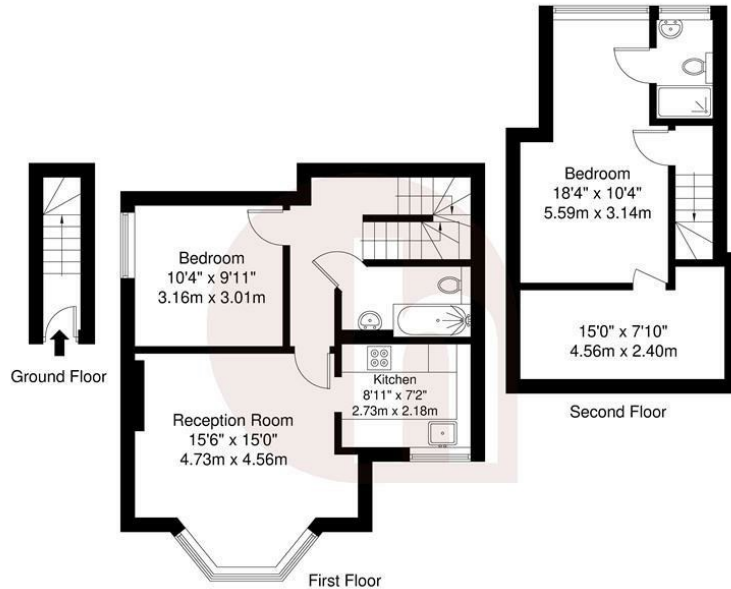

hausman  
& holmes

Golders Green Crescent, Golders Green, NW11  
Asking Price £525,000



- Chain Free
- Two Bathroom
- Easy Access to shops & transport
- Two Double Bedroom
- Spacious 871 sq ft
- Off street parking

**Golders Green Crescent, NW11**

Total Gross Internal Area = 80.9 sq m / 871 sq ft

All Measurements are approximate and for identification guideline purposes only, not to scale.  
Compliant with the RICS code of measuring practice



**020 8458 8555**

57 Golders Green Road

London NW11

info@hausmanandholmes.com

Energy Efficiency Rating		Current	Potential
Very energy efficient - lower running costs			
92 plus	A		
81-91	B		
69-80	C		
55-68	D		
39-54	E		
21-38	F		
1-20	G		
Not energy efficient - higher running costs			
		72	76
England & Wales		EU Directive 2002/91/EC	

Compliant with RICS code of measuring practice, Particulars and floor plans are only a guide to the property and do not constitute or form part of any offer or contract and are not to be regarded as representation of fact. Any intending purchaser must satisfy themselves as to the accuracy of these particulars as they are given without responsibility. No person in the employment of Hausman and Holmes has any authority to make or give representation or warranty to properties being sold.